

1. **Fish-Basket Guanyin**, 1700s–1800s  
 China, Qing dynasty (1644–1911)  
 ivory, paint  
 Spencer Museum of Art,  
 The University of Kansas  
 William Bridges Thayer Memorial,  
 1928.0569

2. **zushi (portable shrine)**  
**containing Aizen Myōō**, late 1800s  
 Japan, Meiji period (1868–1912)  
 lacquer, wood, paint, carving  
 Spencer Museum of Art,  
 The University of Kansas  
 William Bridges Thayer Memorial,  
 1928.1821

3. **Daruma**, early 1800s  
 Japan, Edo period (1600–1868)  
 wood, gesso, pigments, gilding, carving  
 Spencer Museum of Art,  
 The University of Kansas  
 Charles and Mary Margaret Clevenger  
 Art Acquisition Fund, 2012.0093.a-c

4. **Daruma nesting dolls**, late 1900s  
 Japan, Heisei period (1989–2019)  
 wood, paint, carving  
 Spencer Museum of Art,  
 The University of Kansas  
 Gift of William A. Scott, 2007.0156.01-5

5. **Ebisu** (left) and **Daikoku** (right),  
 early 1900s  
 Japan, Meiji period (1868–1913)  
 wood  
 Spencer Museum of Art,  
 The University of Kansas  
 William Bridges Thayer Memorial,  
 1928.2837 & 1928.2683

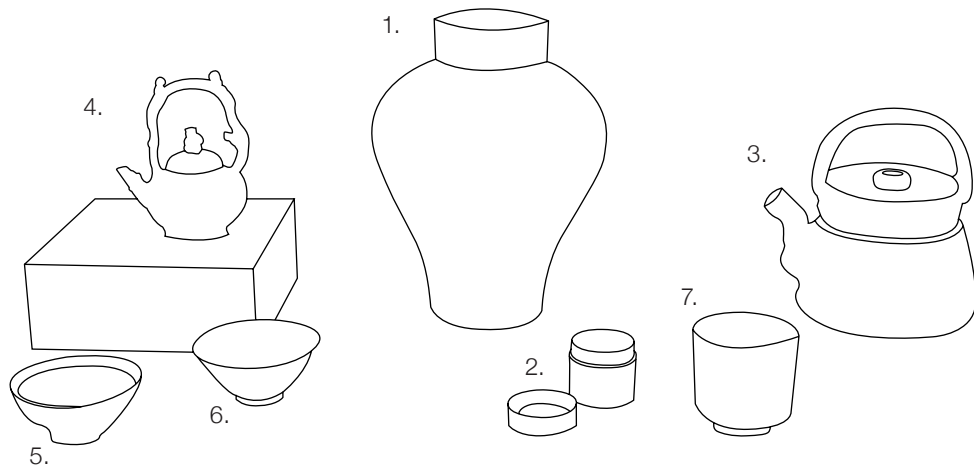

1. **dragon vase**, 1800s  
 Korea, Joseon Dynasty (1392–1910)  
 blue-and-white porcelain  
 Spencer Museum of Art,  
 The University of Kansas  
 Promised Gift of the Weare-West Family  
 Trust, PG2017.004

2. **natsume (tea caddy)**, late 1700s  
 Japan, Edo period (1600–1868)  
 lacquer, gold, silver, lead, wood  
 Spencer Museum of Art,  
 The University of Kansas  
 William Bridges Thayer Memorial,  
 1929.0013.a,b

3. **water ewer**, late 1800s  
 Japan, Meiji period (1868–1912)  
*oribe* stoneware  
 Spencer Museum of Art,  
 The University of Kansas  
 Gift of Jay Gates, Director. Spencer  
 Museum of Art, 1984–1987,  
 2012.0604.a,b

4. **teapot with monkeys**, early 1900s  
 China, Republic of China (1912–1949)  
*yixing* (purple sand) stoneware  
 Spencer Museum of Art,  
 The University of Kansas  
 Gift of Jay Gates, Director, Spencer  
 Museum of Art, 1984–1987,  
 2014.0128.a,b

5. **tea bowl**, 1100s  
 China, Song dynasty (960–1279)  
*jian* ware, stoneware, glazing  
 Spencer Museum of Art,  
 The University of Kansas  
 Gift of Mrs. Marc Hansen, 1978.0103

6. **tea bowl**, 1500s  
 Korea, Joseon dynasty (1392–1910)  
*buncheong* ware, stoneware, glazing  
 Spencer Museum of Art,  
 The University of Kansas  
 William Bridges Thayer Memorial,  
 1928.0432

7. **tea bowl**, 1700s  
 Japan, Edo period (1600–1868)  
*karatsu* ware, gold lacquer repair  
 Spencer Museum of Art,  
 The University of Kansas  
 Gift from the Jedel Family Foundation,  
 2006.0265

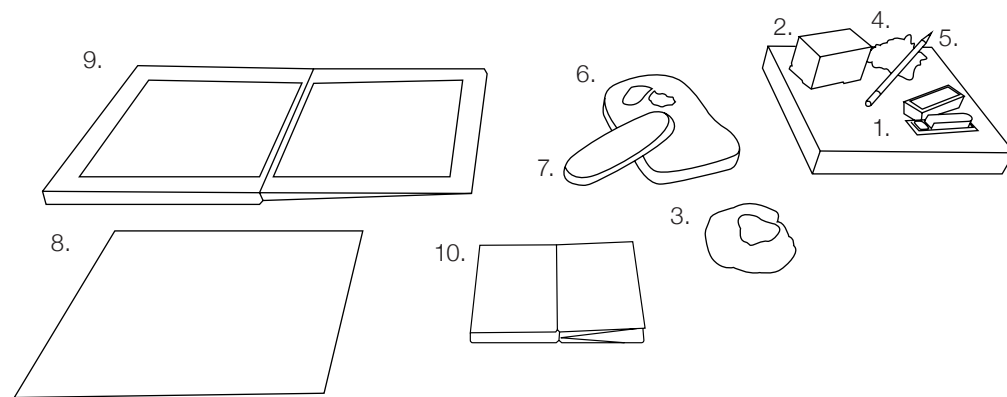

1. **seal with container and paste**,

early 1900s

China, Republic of China (1912–1949)

stone, wood, vermillion

Spencer Museum of Art,

The University of Kansas

Gift of Jay Gates, Director, Spencer

Museum of Art, 1984–1987,

2014.0134.a,b,c

2. **water dropper**, 1700s–1800s

Korea, Joseon dynasty (1392–1910)

blue-and-white porcelain, crazing

Spencer Museum of Art,

The University of Kansas

Gift of Marsha and Christopher Haufler,

2017.0112

3. **brush washer with plum branches**,

early 1900s

China, Republic of China (1911–1949)

wood

Spencer Museum of Art,

The University of Kansas

Gift of Jay Gates, Director, Spencer

Museum of Art, 1984–1987, 2012.0632

4. **brush rest with deer figurine**,

1800s

China, Qing dynasty (1644–1911)

soapstone

Spencer Museum of Art,

The University of Kansas

William Bridges Thayer Memorial,

1928.3019

5. **brush**, 1990s

China, People's Republic of China

(1949–present)

wood, hair

Spencer Museum of Art,

The University of Kansas

Gift of Jay Gates, Director, Spencer

Museum of Art, 1984–1987,

2014.0132.05

6. **ink stone**, late 1800s

China, Qing dynasty (1644–1911)

duan stone

Spencer Museum of Art,

The University of Kansas

Gift of Irma Lutz Ebnother in memory of

her parents, Dr. and Mrs. Ernest J. Lutz,

1979.0059

7. **“national treasure” (guo bao 國寶)**

**ink cake**, early 1900s,

Republic of China (1911–1949)

ink, carving

Spencer Museum of Art,

The University of Kansas

William Bridges Thayer Memorial,

1928.3000

8. **Jieziyuan Huazhuan**

**(Manual of Mustard Seed Garden)**,

late 1800s

China, Qing dynasty (1644–1911)

woodcut

Spencer Museum of Art,

The University of Kansas

Gift of Mrs. Arthur S. Johnson

(The May Finney Marcy Collection),

1964.0077

9. **Qin Yuqi**

active China, late 1800s–early 1900s

**Album of 12 Plum Blossoms**

**(with facing calligraphy)**, 1888

Qing dynasty (1644–1911)

ink on paper

Spencer Museum of Art,

The University of Kansas

Gift of Dr. William P. Fenn, 1977.0127.02

10. **Zhang Xiong** (1803–1886)

born Xiushui (present-day Jiaxing),

Zhejiang province, China

**One Hundred Flowers Unfolding**

**in Your Palm**, 1800s,

Qing dynasty (1644–1911)

ink on paper

Spencer Museum of Art,

The University of Kansas

Source unknown, 1969.0063.01

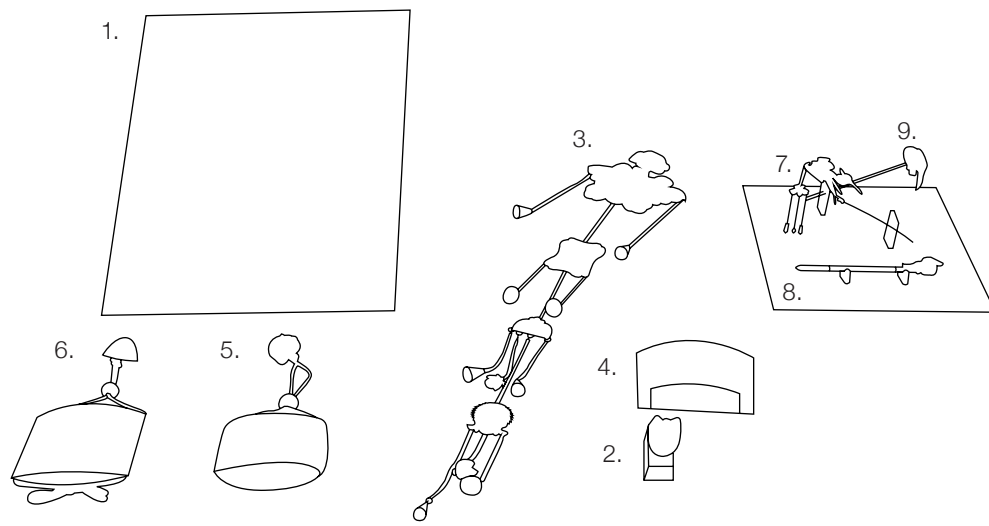

1. **Toyohara Chikanobu** (1838–1912)  
 born Takada, Echigo province  
 (present-day Niigata prefecture), Japan  
**jūichigatsu (The Eleventh Month)**,  
 1890, Meiji period (1868–1912)  
 color woodcut  
 Spencer Museum of Art,  
 The University of Kansas  
 Museum purchase: Lucy Shaw Schultz  
 Fund, 2007.0062.11

2. **Deme Uman**  
 active Japan, Edo period (1600–1868)  
**netsuke (fox mask)**, circa 1772–1780  
 wood, paint  
 Spencer Museum of Art,  
 The University of Kansas  
 William Bridges Thayer Memorial,  
 1928.0262

3. **tassel**, late 1800s  
 China, Qing dynasty (1644–1911)  
 silk, enamel  
 Spencer Museum of Art,  
 The University of Kansas  
 Source unknown, 0000.1165

4. **kushi (comb) with butterflies**, 1800s  
 Japan, Edo period (1600–1868)  
 lacquer, wood, mother of pearl, gilding  
 Spencer Museum of Art,  
 The University of Kansas  
 William Bridges Thayer Memorial,  
 1928.0212

5. **inro, netsuke, ojime**, 1800s  
 Japan, Edo period (1600–1868)  
 wood, ivory  
 Spencer Museum of Art,  
 The University of Kansas  
 William Bridges Thayer Memorial,  
 1928.0140.a,b,c

6. **Shiomi Masanari** (1647–1722)  
 born Kyoto, Japan  
**inro, netsuke, ojime**  
**(fox wedding scene)**, early 1700s  
 Edo period (1600–1868)  
 lacquer, gold, ivory, wood  
 Spencer Museum of Art,  
 The University of Kansas  
 William Bridges Thayer Memorial,  
 1928.0031.a,b,c

7. **Cai Xinchun**  
 active China, Qing dynasty (1644–1911)  
**hair ornament**, late 1800s  
 gold filigree, brass, pearl, jade, glass,  
*diancui* (inlaid feathers)  
 Spencer Museum of Art,  
 The University of Kansas  
 William Bridges Thayer Memorial,  
 1928.0324

8. **binyeo (hair ornament)**, late 1800s  
 Korea, Joseon dynasty (1392–1910)  
 bronze, casting, coral, gilding  
 Spencer Museum of Art,  
 The University of Kansas  
 William Bridges Thayer Memorial,  
 1928.0318

9. **kanzashi hairpin**, 1800s  
 Japan, Edo period (1600–1868)  
 coral, silver, gold  
 Spencer Museum of Art,  
 The University of Kansas  
 William Bridges Thayer Memorial,  
 1928.0230